

**TOP-MOUNT Decking-Ready
Tread Layout for Ø60" Spiral**

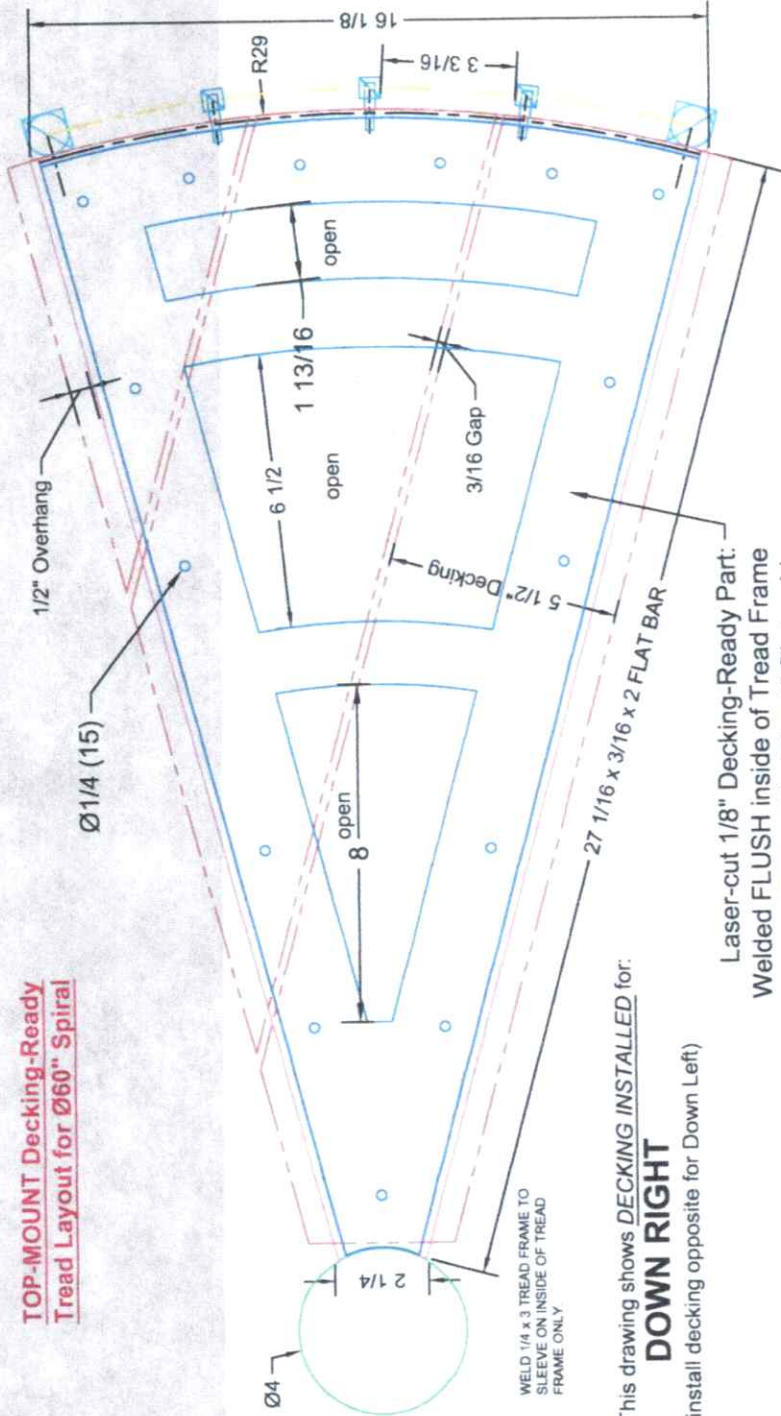

This drawing shows **DECKING INSTALLED** for:
DOWN RIGHT
(install decking opposite for Down Left)

Laser-cut 1/8" Decking-Ready Part:
Welded FLUSH inside of Tread Frame
-weld to tread frame with 1/8 x 1" fillet welds

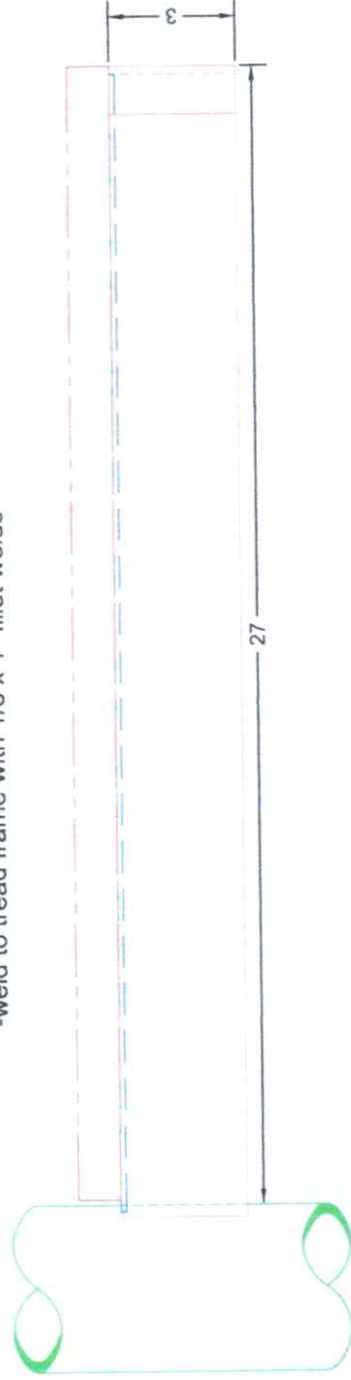

**Laser-Cut Decking-Ready
D-Platform Layout for Ø60" Steel Spiral**

DOWN-RIGHT SHOWN
--to accept 5-1/2" wide Decking--

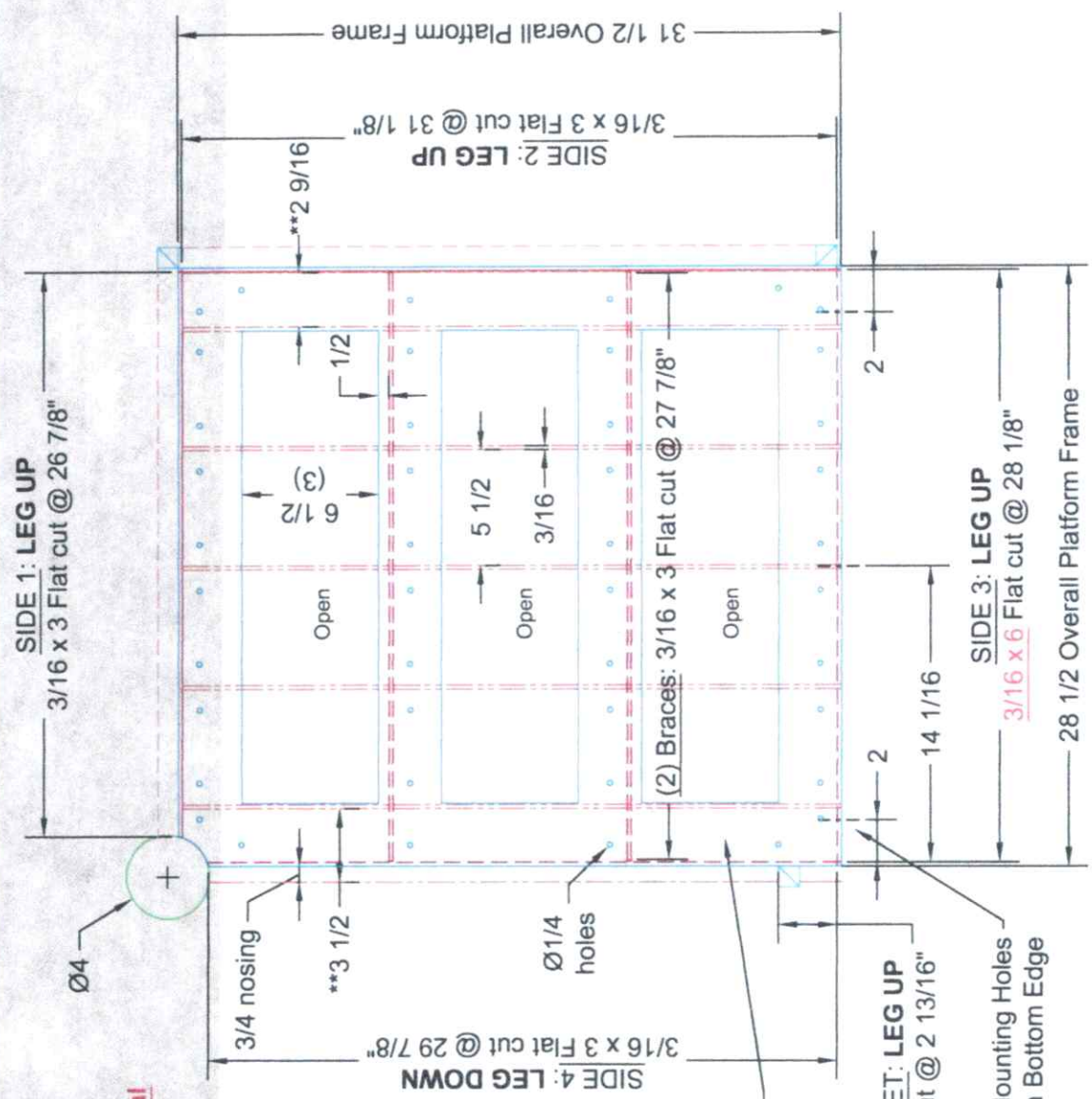

1/8" Smooth Steel laser-cut as shown.
(sides welded above or below)

(3x) Ø7/16 Mounting Holes
1" OC up from Bottom Edge

STAIR SPECIFICATIONS

- Headroom : 84 5/16
- Spiral Rail Cap: Std Ornamental steel railcap
- Hand Rail Width: 1 3/4 ; Handrail Height : 34 3/8
- Railcap will ship in: 3 pcs.
- Main Balusters : 1 in Square steel Tube
- 3 Mid Baluster per Tread. Approximate Space = 3 1/4
- Mid Baluster Desc.: 1/2 in Square steel
- Riser Style: None ; Column Cap: Painted Cap
- Welded steel , 30.0 Degree Tread Frame x
- Tread Cover: 1" x 5-1/2" DECKING BY OTHERS
- Platform Cover: 1" x 5-1/2" DECKING BY OTHERS

**Design 100
60 in , Down Right**

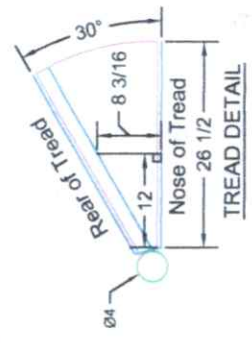
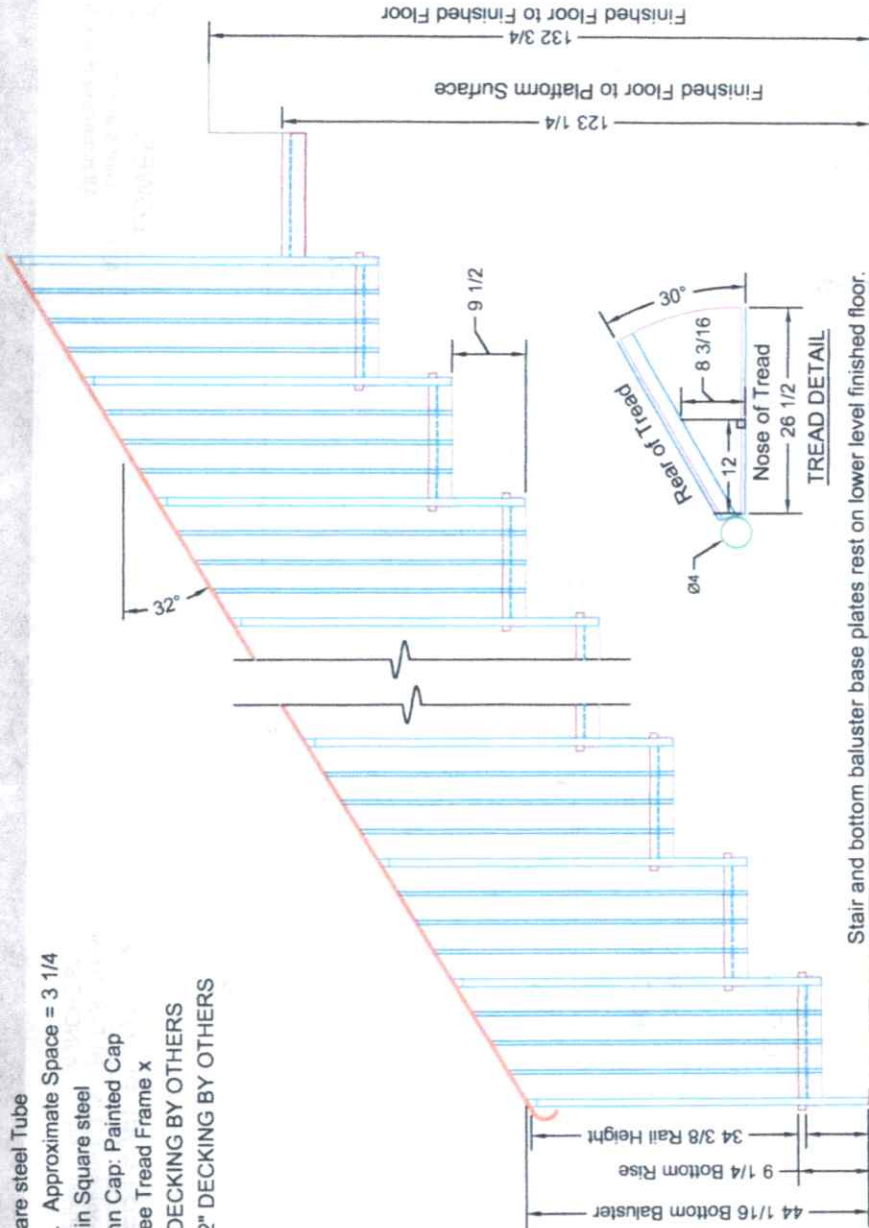

Stair and bottom baluster base plates rest on lower level finished floor.
FASTENERS TO ANCHOR STAIR ARE BY OTHERS

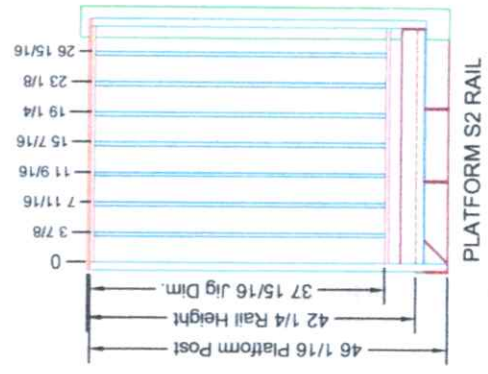
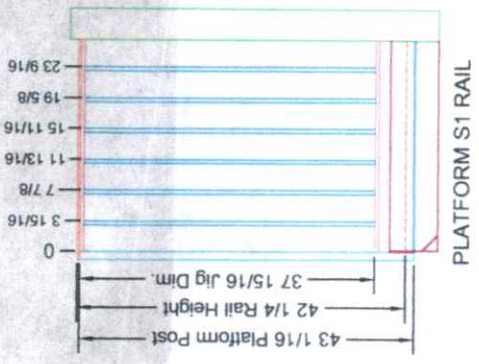

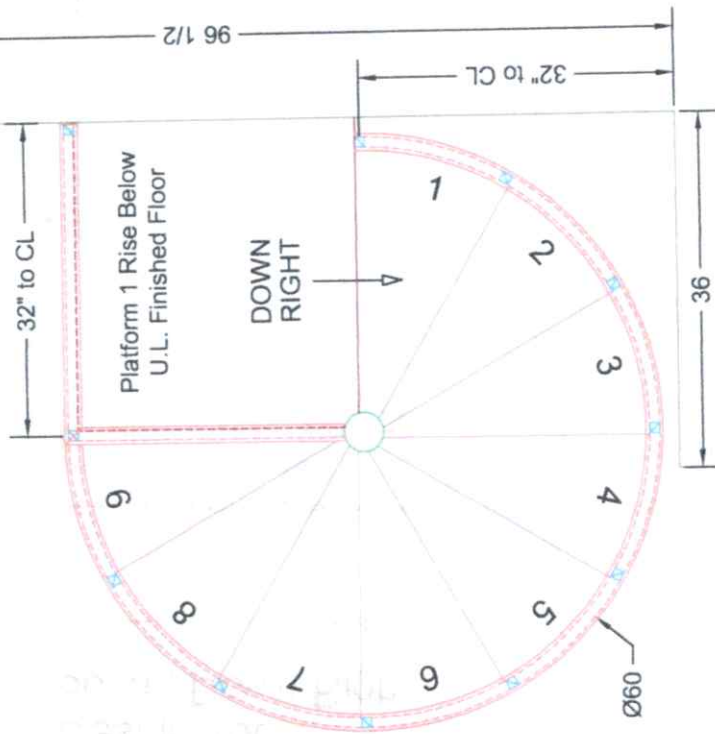

UPPER LEVEL PLAN VIEW

* All dimensions are to FINISHED SURFACES*

* All dimensions are in INCHES*

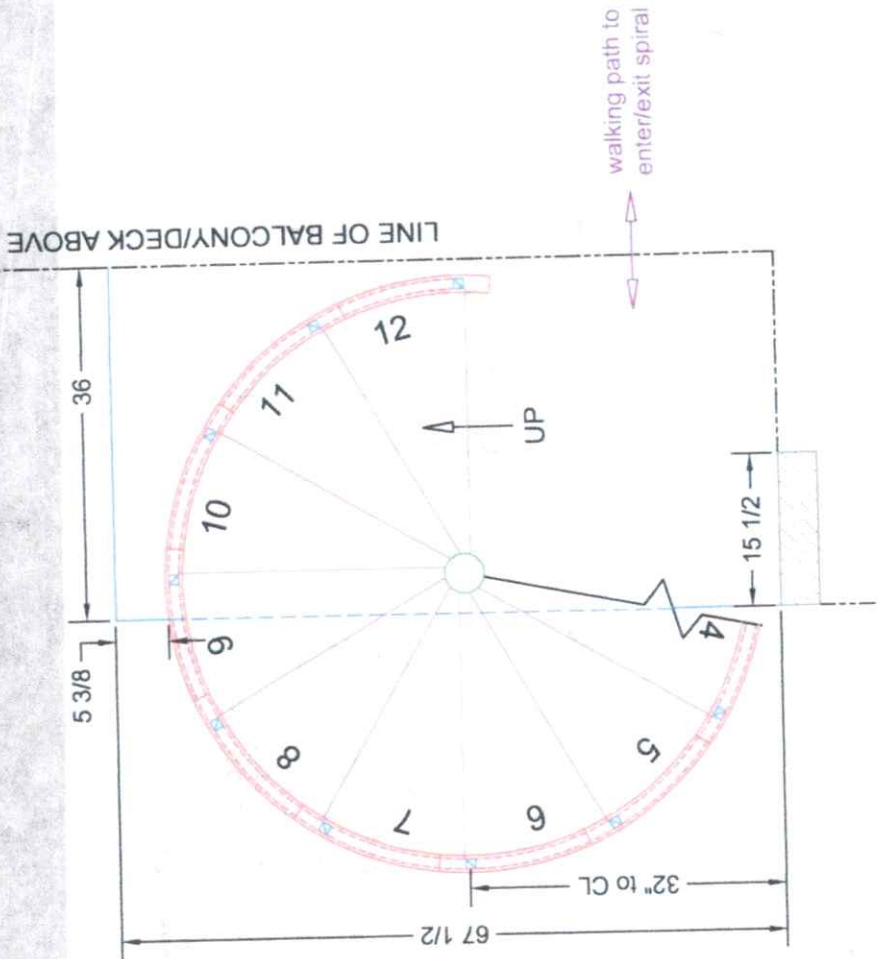

LOWER LEVEL PLAN VIEW

* All dimensions are to FINISHED SURFACES*

* All dimensions are in INCHES*